

TUBE-STYLE BANNER 2FT. BASE X 9.5FT.

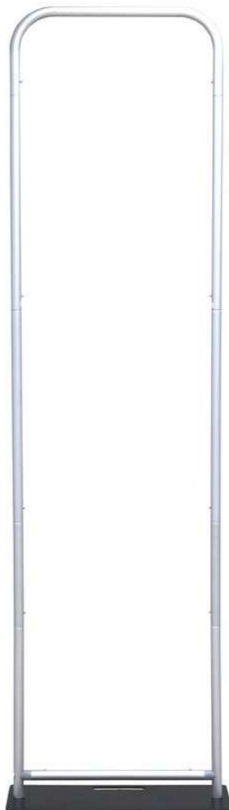

Shown with standard packaging



Shown with optional Silver bag

PRODUCT DESCRIPTION

Expedite your banner stand setup time while adding lavish appeal with our newest Tube fabric display! Hardware comes stock at 7.5' and 5.5' tall with height options of 8.5', 9.5', and 11.5' with the use of optional 2ft extension poles. Customize a single-sided (choose white or black back fabric) or double-sided dye-sublimated stretch fabric print. To assemble, secure the longest vertical poles onto the black steel base using the included allen wrench. Add the bottom horizontal support pole and secure. Snap on the remaining vertical poles, then top frame with the curved bar to complete. Tilt or lay down the frame to swiftly drape with the pillowcase graphic. Using the industrial-sized zipper, zip underneath the bottom support pole, maximizing fabric tension.

DISPLAY DIMENSIONS	25.5"W x 66", 90", 114", or 138"H x 10"D
GRAPHIC SIZE	26" W x 66", 90", 112", or 138"H

GRAPHIC MATERIAL

Stretch fabric

GRAPHIC FINISHING

Sewn on left, right, and top with a zipper at the bottom

DISPLAY CONSTRUCTION

Steel base with aluminum tube frame (1.125" / 28.5mm dia.)

SHIPPING WEIGHTS & DIMENSIONS

Shipping Weight	13 lbs (stand only) 15 lbs (with graphic)
Shipping Dimensions	31"L x 11"W x 4"H

LARGE QUANTITY FREIGHT

Freight Shipping	60 boxes per 48"L x 40"W x 40"H skid
Freight Weight	816 lbs (frame only) 936 lbs (frame and graphic)



Silver light

TUBE-STYLE BANNER 2FT. BASE X 9.5FT.

PARTS LIST

Based on 24 x 90 frame



Qty.1 - Steel base w/ allen key & screws

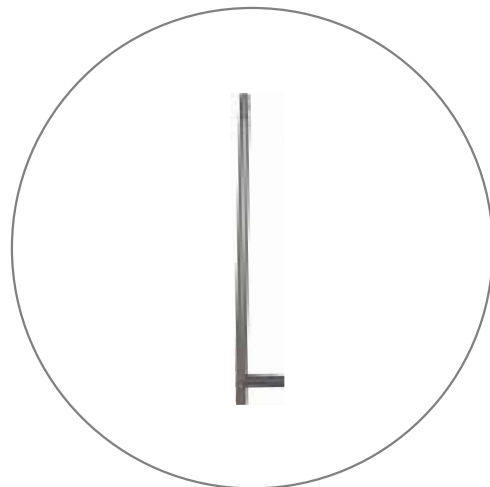

Qty.2 - 20" tube



Qty.4 - 24" tube



Qty.2 - 12" tube

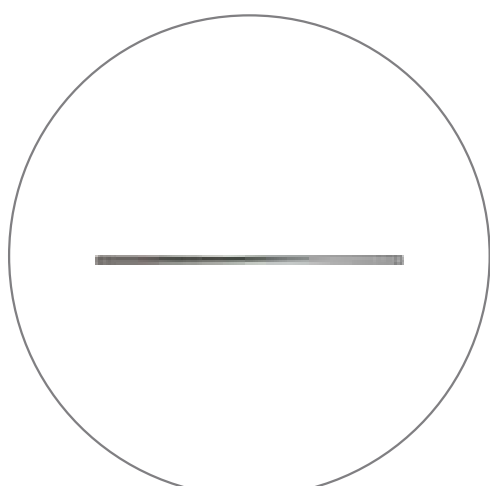

Qty.1 - 24" Bottom tube



Qty.1 - 24" Top tube

SET UP INSTRUCTIONS

Based on 36"x90" frame

Step 1

Remove all pieces from the box or case.



Step 2

Connect (2) 32" vertical tubes to the horizontal support bar.

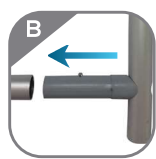
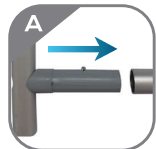

Step 3

Secure the (2) 32" vertical tubes to the black steel base using the supplied screws and allen key.



Step 4

Snap on the remaining 24" vertical poles.

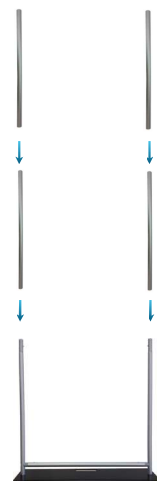

Step 5

Then top the frame with the 36" top tube.

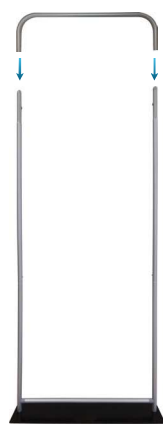

Step 6

The frame is ready for the graphic to be installed.

